



## EN-SUITE, ART-DECO BATH FOR A YOUNG GIRL

### new

1. faucet and shower fixture
2. vanity base (provided)
3. quartz counter, mitered front and side, under-mount sink
4. replace light over mirror, and one overhead
5. install new medicine cabinet
6. tile: floor, shower walls, shower floor as shown
7. tile in glass corner shelves
8. curb for shower 4"H x 5"W
9. shower door glass, hardware tbd with installer, gold finish
10. paint: walls and trim
11. ALSO paint Stella's bedroom
12. ALSO replace Stella's bedroom light fixture
13. install towel bars, three shelves and accessories
14. replace supply lines and lever for toilet, gold finish
15. replace shower drain cover, schluter, vintage gold
16. replace fan with one with timer and sensor

### keep

1. plumbing placement
2. toilet
3. ceiling remains with lights and vents in place.
4. crown molding and baseboard remains



# MEASUREMENTS and blocking

ceiling height 99"

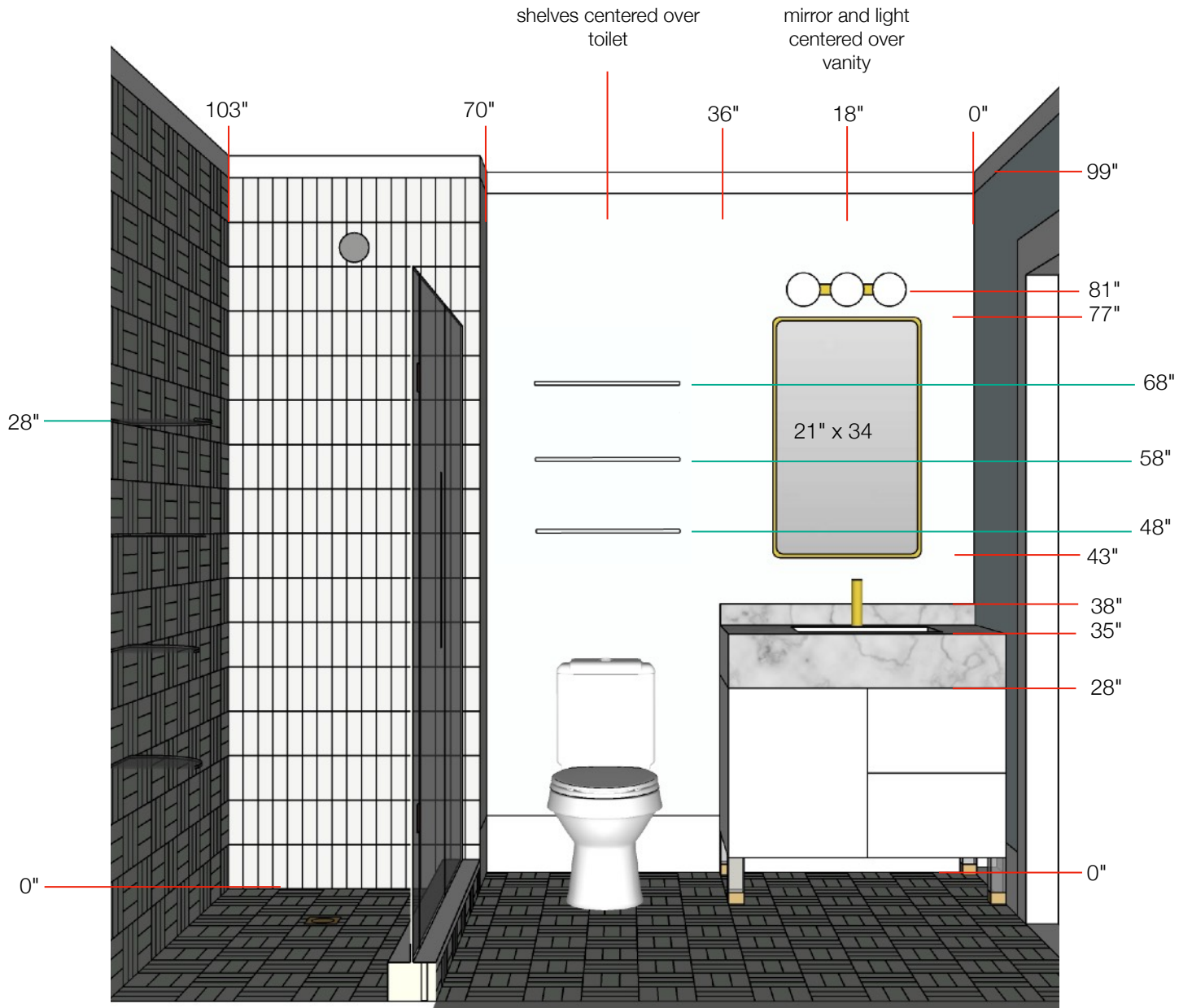

curb is 4"H x 5"W



**TILE: FIRECLAY**

**Basket weave pattern**, colors Salton Sea, French Linen  
main floor, shower floor, one shower wall, curb outside and curb inside

**half: 2" x 6"** color: Salton Sea

**half: 2" x 6"** color: French Linen

**2" x 6"** vertical - color French Linen  
shower walls

**2" x 6"** vertical, long finished edge - color French Linen  
edges of two shower walls

**grout for all tile:** Laticrete, Light Pewter sanded grout (RBW purchase)

**curb top (Gerrity Stone):** ALPINE MIST 2cm  
match floor pattern for sides of curbs

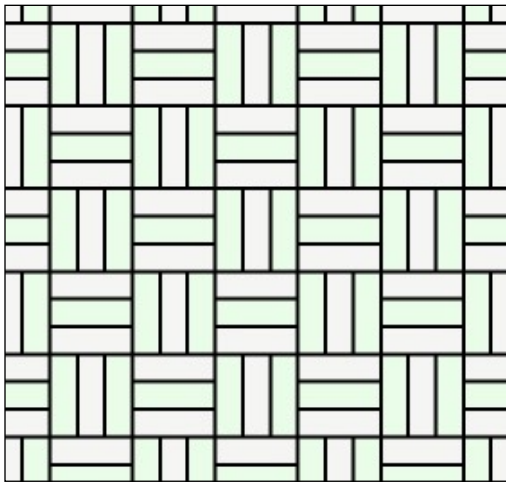

pattern for floor and back wall of shower

**PAINT:** Benjamin Moore

bathroom and bedroom trim: White Dove, semi-gloss

bathroom wall: Snowfall White OC-118, Aura Bath & Spa - eggshell

Stella bedroom wall: Paper White 1590 - matte

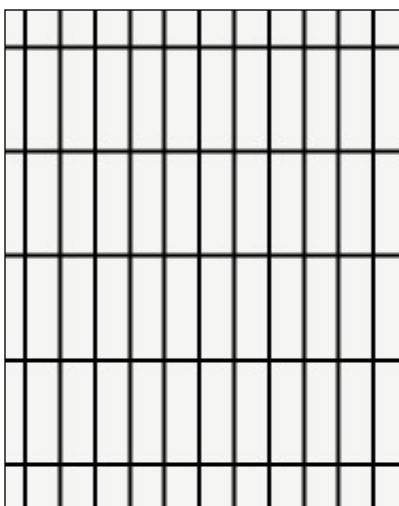

pattern for all other walls

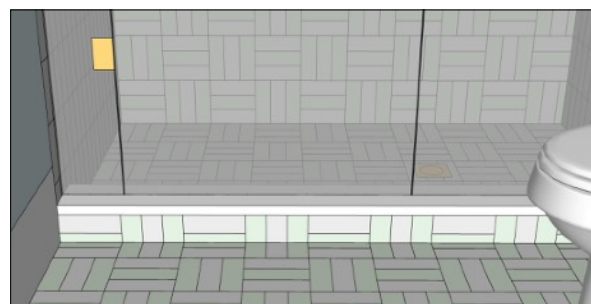

detail of curb, continuation of pattern for curb inside and outside



4" schluter drain  
floral brushed vintage gold  
(RBW purchase)



(4) 9" glass shelves

# TILE

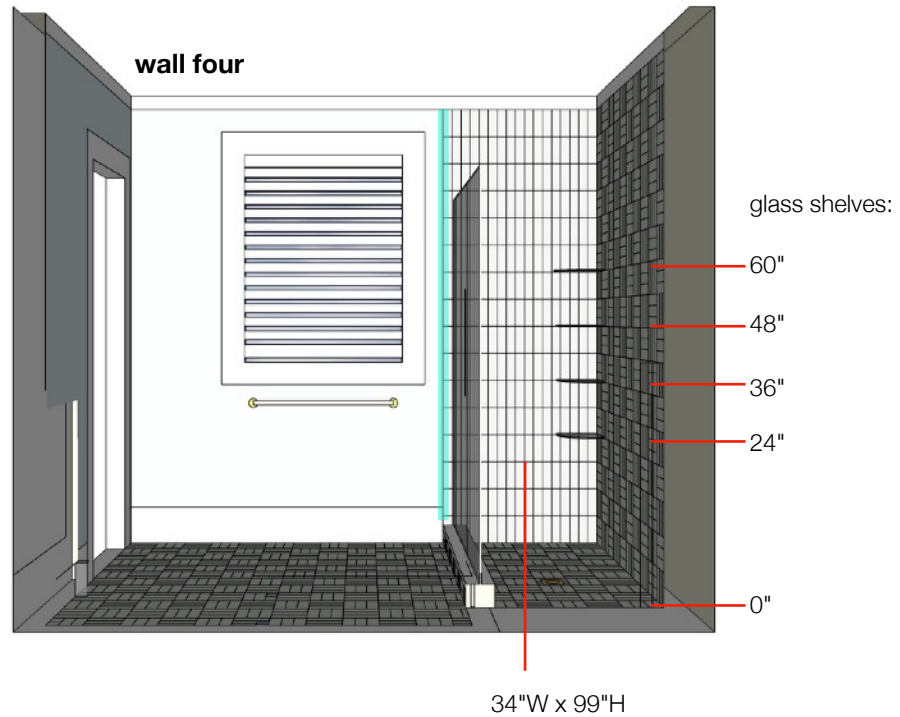
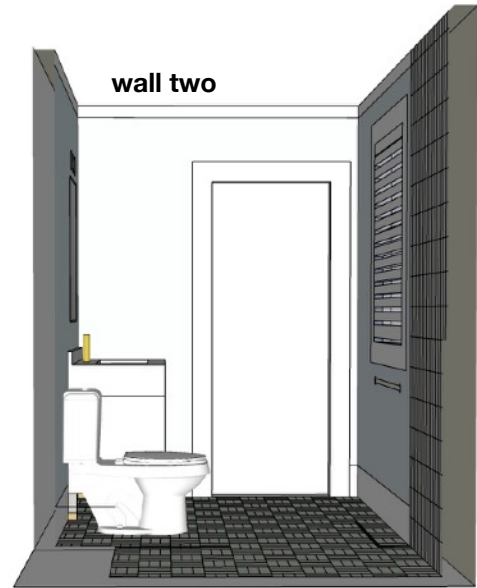
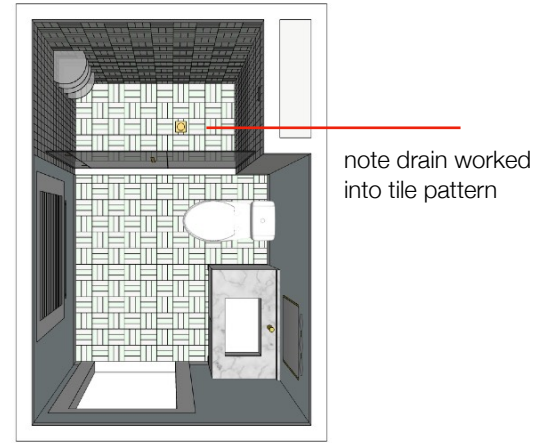

note how floor pattern continues up to the front of the curb, and same in the rear. Topped with .75" curb top.

blue lines show tile with glazed edge for finishing

**TILE: shelves and [fireclaytile.com](http://fireclaytile.com)**

(4) 9" glass shelves



Install four glass shelves with tile.  
12" apart in corner.

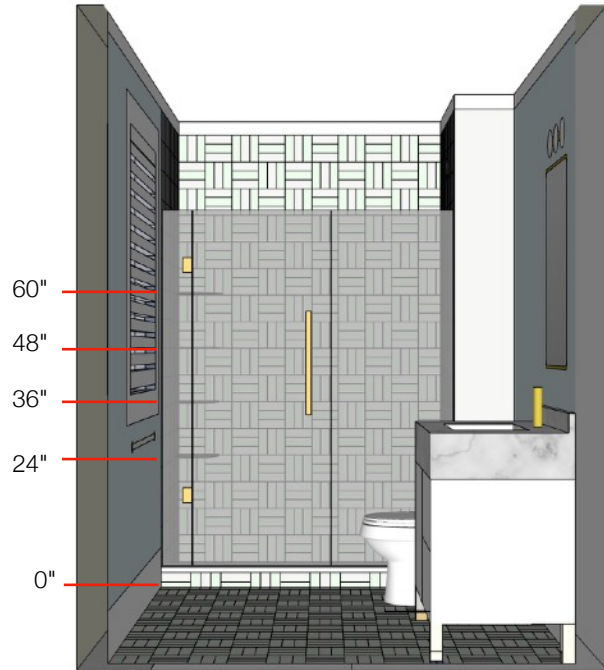

Below are Fireclay installation notes from my rep [terapan@fireclaytile.com](mailto:terapan@fireclaytile.com)  
The website has lots of tips on installing this type of handcut tile

Of note, since I see you are suggesting a parquet design with the 2x6 tiles  
Please keep in mind when blending sizes that our ceramic tiles are not modular as they are handmade & hand-cut. Slight grout irregularity is to be expected when blending different sizes— a larger grout joint is more forgiving, while a tighter grout joint will accentuate the nominal size variance

Here is the approx size of the 2x6

2 x 6	1-15/16" x 6"
-------	---------------

We typically recommend using SANDED grout for our handmade ceramic tiles

For sealer—

I typically recommend [Miracle Cover](#) – Our Creative Director raves about it & says the

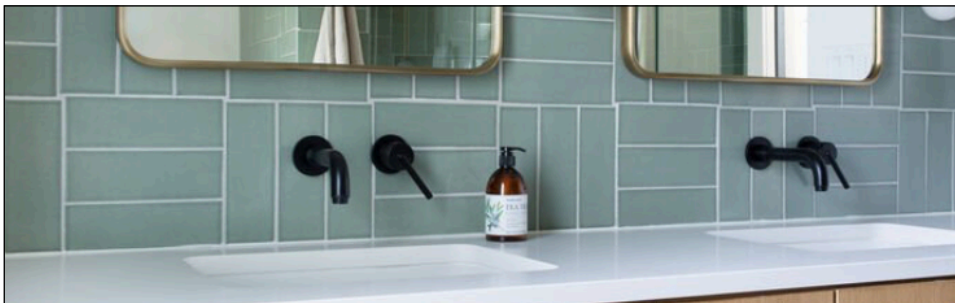

Don't want parquet to look like this.  
Discuss grout line prior to install



# VANITY

custom made medicine cabinet, being built by <https://modshop1.com>

base only, quartz counter will be ordered on site



faucet: Crosswater Mpro single hole, brushed brass finish  
6.5" high

vanity similar to this picture  
36W x 22D  
total height: 35"H  
cabinet height (no legs or counter): 21"H  
lucite feet with metal caps: 7"H  
**vanity counter (Gerrity Stone): ALPINE MIST,**  
3" backsplash, 7" apron front and side

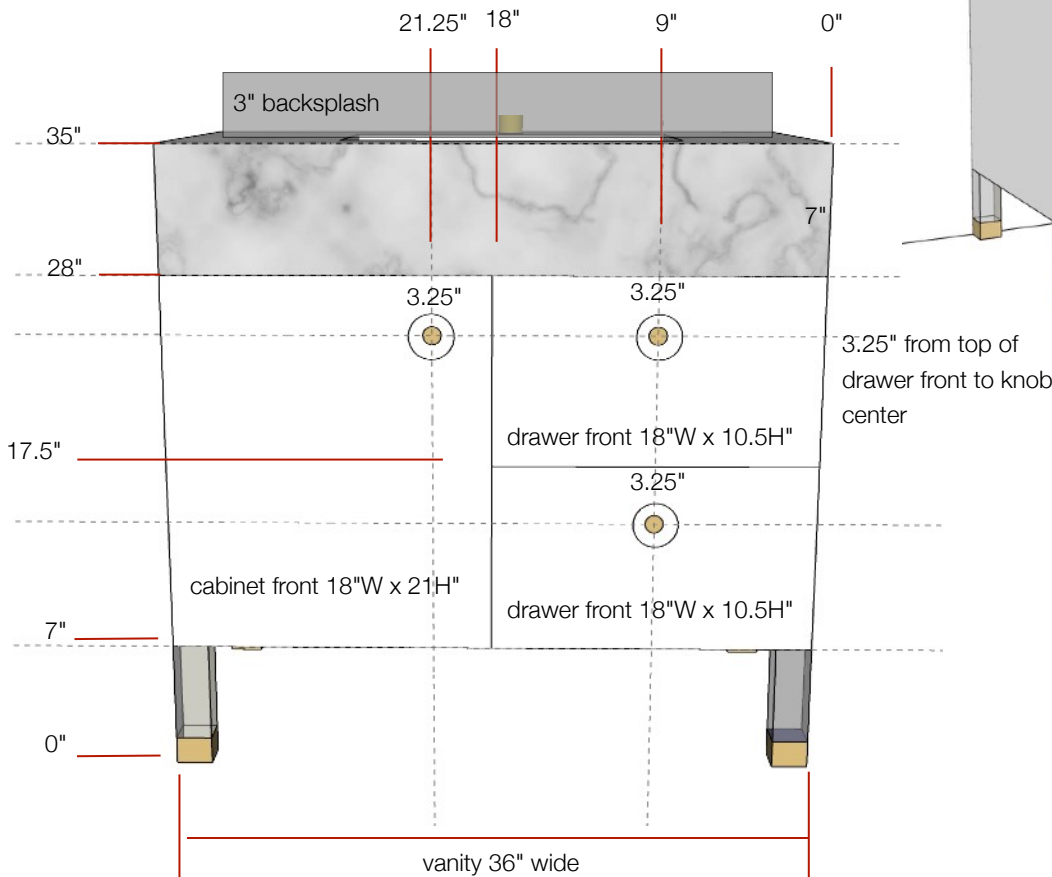
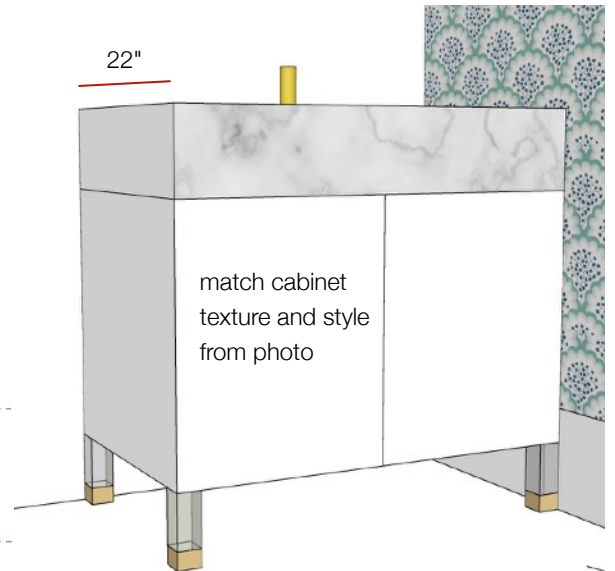

<https://modshop1.com/collections/furniture-hardware/products/2-5-round-lucite-pull?variant=11571357697>

## UNDERMOUNT SINK



### Dart Small Rectangular Vanity

**Model:** CH6360 White

**Model:** CH6365 Bisque

- Vitreous China
- Undermount w/overflow
- 18" x 13"
- 6" Depth
- Gloss Finish
- Template

Spec Sheet

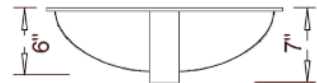
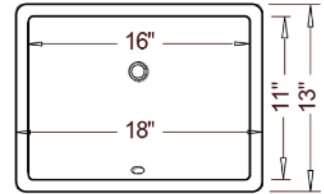

[http://elitebychemcore.com/chemcore/uploads/2016/03/chemcore\\_sink\\_specification\\_sheet-chinashell\\_ch-636xdart.pdf](http://elitebychemcore.com/chemcore/uploads/2016/03/chemcore_sink_specification_sheet-chinashell_ch-636xdart.pdf)

**ACCESSORIES**

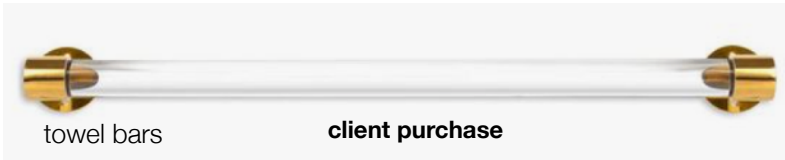

<https://modshop1.com/collections/bathroom-fixtures>

31" towel bar

TP holder

hook



faucet: Crosswater Mpro single hole  
Mpro 1000 thermo trim  
brushed brass finish

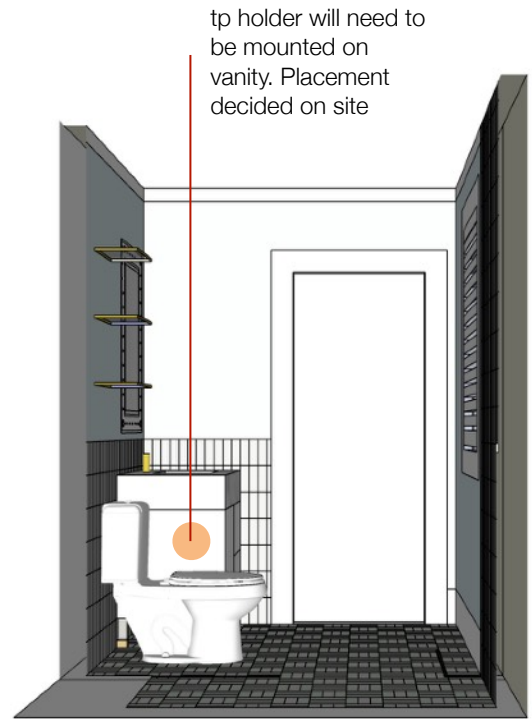
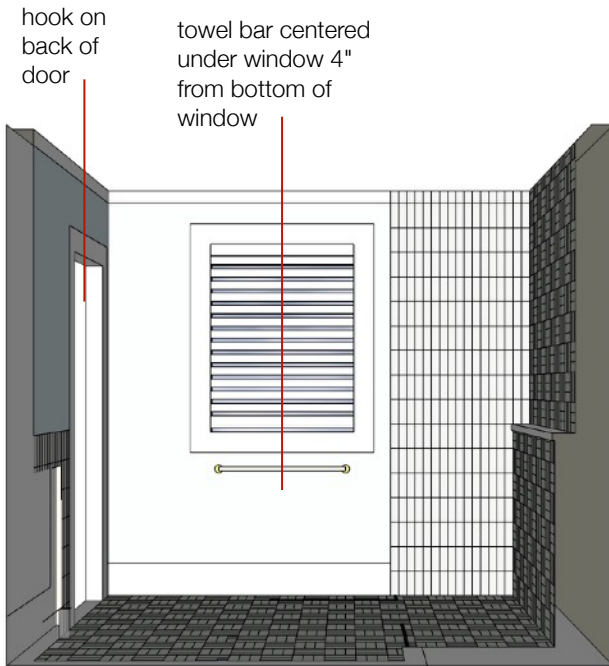

<https://www.potterybarn.com/products/vintage-recessed-medicine-cabinet/>  
21" x 34"

<https://www.rejuvenation.com/catalog/collections/yaquina-20-glass-shelf-set>

20" x 5.5"  
(3)





**LIGHT FIXTURES**



[https://www.lampsplus.com/products/ HUDSON-VALLEY-LETTIE-10-AND-THREE-QUARTER-INCH-W-AGED-BRASS-LED-CEILING-LIGHT\\_24m98.html](https://www.lampsplus.com/products/ HUDSON-VALLEY-LETTIE-10-AND-THREE-QUARTER-INCH-W-AGED-BRASS-LED-CEILING-LIGHT_24m98.html)

Hudson Valley Lettie 10 3/4"W Aged Brass LED Ceiling Light

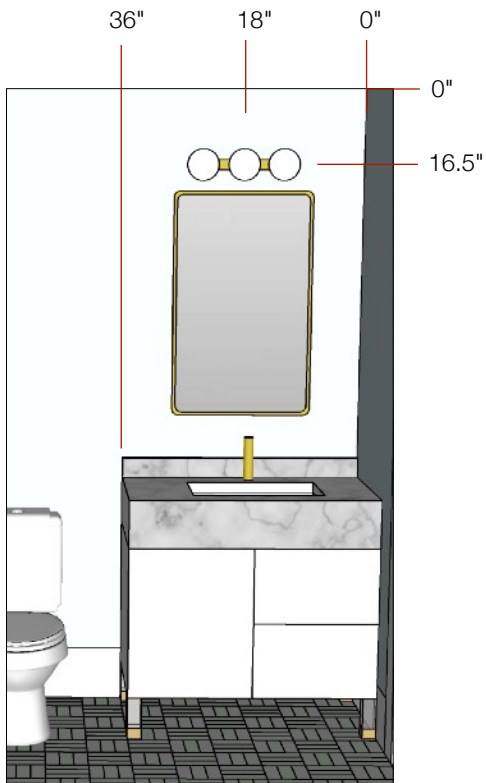
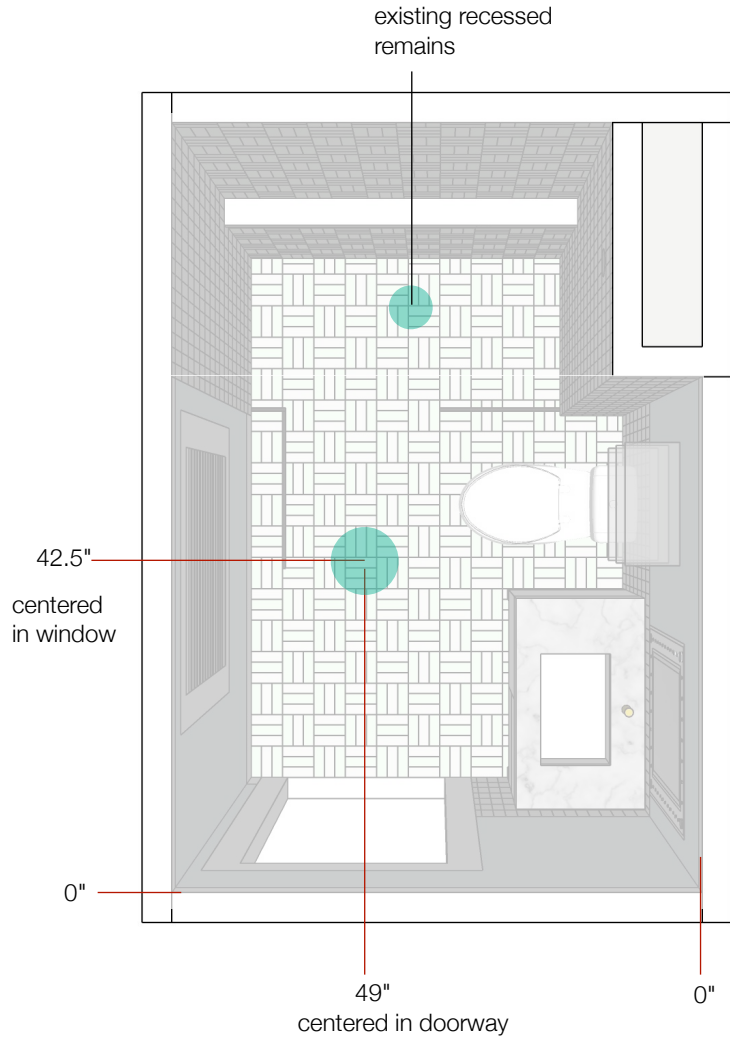

[https://www.lampsplus.com/products/ HUDSON-VALLEY-BAIRD-17-INCH-W-3-LIGHT-AGED-BRASS-BATH-LIGHT\\_9m068.html](https://www.lampsplus.com/products/ HUDSON-VALLEY-BAIRD-17-INCH-W-3-LIGHT-AGED-BRASS-BATH-LIGHT_9m068.html)

Hudson Valley Baird 17"W 3-Light Aged Brass Bath Light

\$412.00